

# MAJESTIC FREEWAY BUSINESS CENTER

## RIVERSIDE COUNTY, CA

INDUSTRIAL WAREHOUSE SPACE AVAILABLE FOR LEASE



**Building 15 - 83,449 SF**

- ▶ Offices to Suit
- ▶ ESFR Fire Sprinkler System
- ▶ Warehouse Lighting to Suit
- ▶ Ample Auto & Trailer Parking
- ▶ Immediate Access to I-215 via Cajalco Road & Harley Knox Boulevard

**For more information, contact:**

Taylor Talt  
D-(562) 654-2734 C-(626) 660-8829  
R.E. License #01901707 (CA)  
Ttalt@MajesticRealty.com

John Semcken  
D-(562) 948-4306 C-(562)-556-1887  
R.E. License #00979758 (CA)  
JSemcken@MajesticRealty.com

Ed Konjayan  
D-(562) 948-4318  
R.E. License #01403186 (CA)  
EKonjayan@MajesticRealty.com



# MAJESTIC FREEWAY BUSINESS CENTER

## RIVERSIDE COUNTY, CA

**BUILDING 15: 83,449 SF**  
18519 Harvill Avenue, Perris, CA

30'  
Clear  
Height

20  
Dock High  
Doors

67  
Auto  
Parking  
Stalls

### BUILDING 15 SPECS

<b>Total Size</b>	83,449 SF
<b>Loading</b>	Single Loading
<b>Column Spacing</b>	60' x 52' Typical Bay
<b>Speed Bay:</b>	65'
<b>Ramps</b>	2 Grade Level Ramps
<b>Building Depth</b>	185'
<b>Sprinklers</b>	ESFR

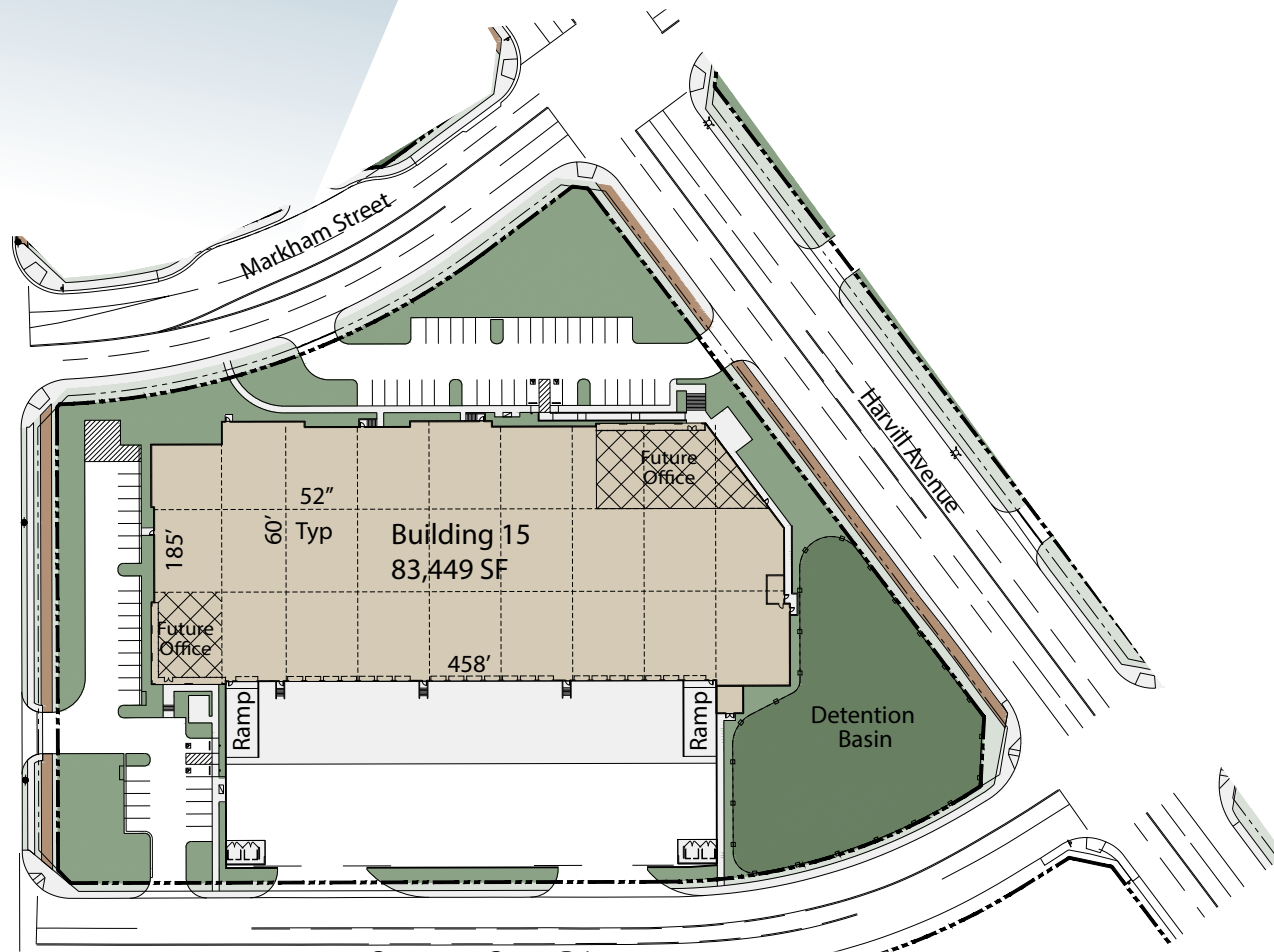

# MAJESTIC FREEWAY BUSINESS CENTER

## RIVERSIDE COUNTY, CA

### LOCATION

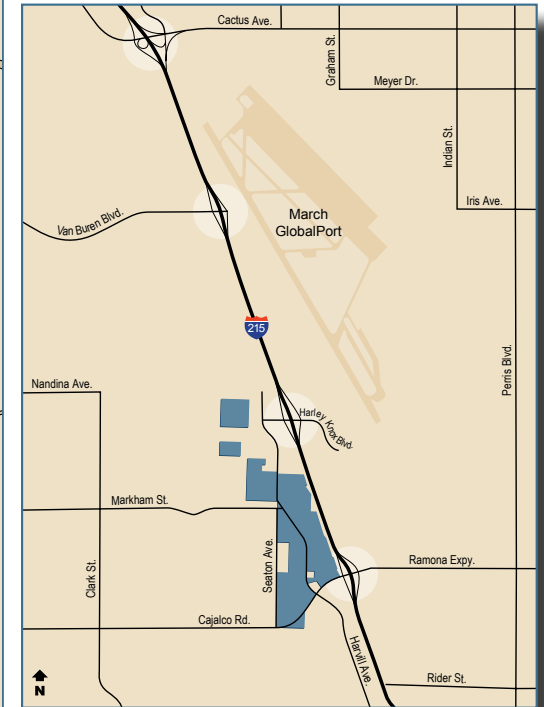

The Majestic Freeway Business Center is located between Harley Knox Boulevard and Cajalco Road on the I-215 Freeway in Riverside County, California.

# MAJESTIC FREEWAY BUSINESS CENTER RIVERSIDE COUNTY, CA

CORPORATE  
NEIGHBORS

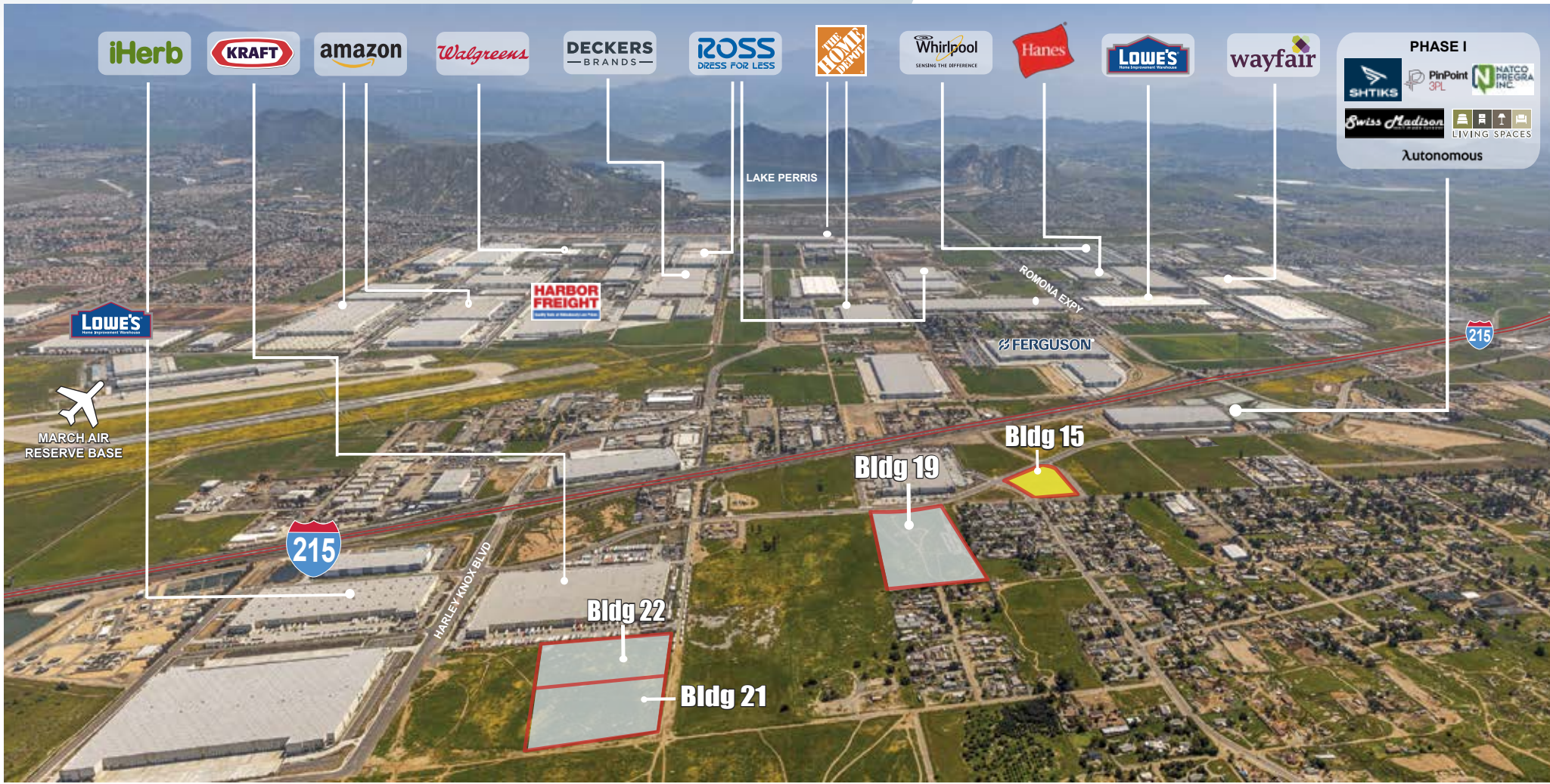

This statement is based upon information which we believe to be correct and is obtained from sources we regard as reliable but we assume no liability for errors or omissions therein.