

MAJESTIC FREEWAY BUSINESS CENTER

RIVERSIDE COUNTY, CA

INDUSTRIAL WAREHOUSE SPACE AVAILABLE FOR LEASE



Building 12 - 147,249 SF

- ▶ Offices to Suit
- ▶ ESFR Fire Sprinkler System
- ▶ Warehouse Lighting to Suit
- ▶ Ample Auto & Trailer Parking
- ▶ Immediate Access to I-215 via Cajalco Road & Harley Knox Boulevard

For more information, contact:

Taylor Talt
D-(562) 654-2734 C-(626) 660-8829
R.E. License #01901707 (CA)
Ttalt@MajesticRealty.com

John Semcken
D-(562) 948-4306 C-(562)-556-1887
R.E. License #00979758 (CA)
JSemcken@MajesticRealty.com

Ed Konjoyan
D-(562) 948-4318
R.E. License #01403186 (CA)
EKonjoyan@MajesticRealty.com



MAJESTIC FREEWAY BUSINESS CENTER RIVERSIDE COUNTY, CA

BUILDING 12: 147,249 SF
18512 Harvill Avenue, Riverside County, CA

BUILDING 12 SPECS

Total Size	147,249 SF
Loading	Rear Loading
Column Spacing	50' x 52' typical bay 60' x 52' speed bay
Ramps	2 grade level ramps
Building Depth	320'
Sprinklers	ESFR

32'
Clear
Height

19
Dock High
Doors

100
Auto
Parking
Stalls

24
Trailer
Parking
Stalls

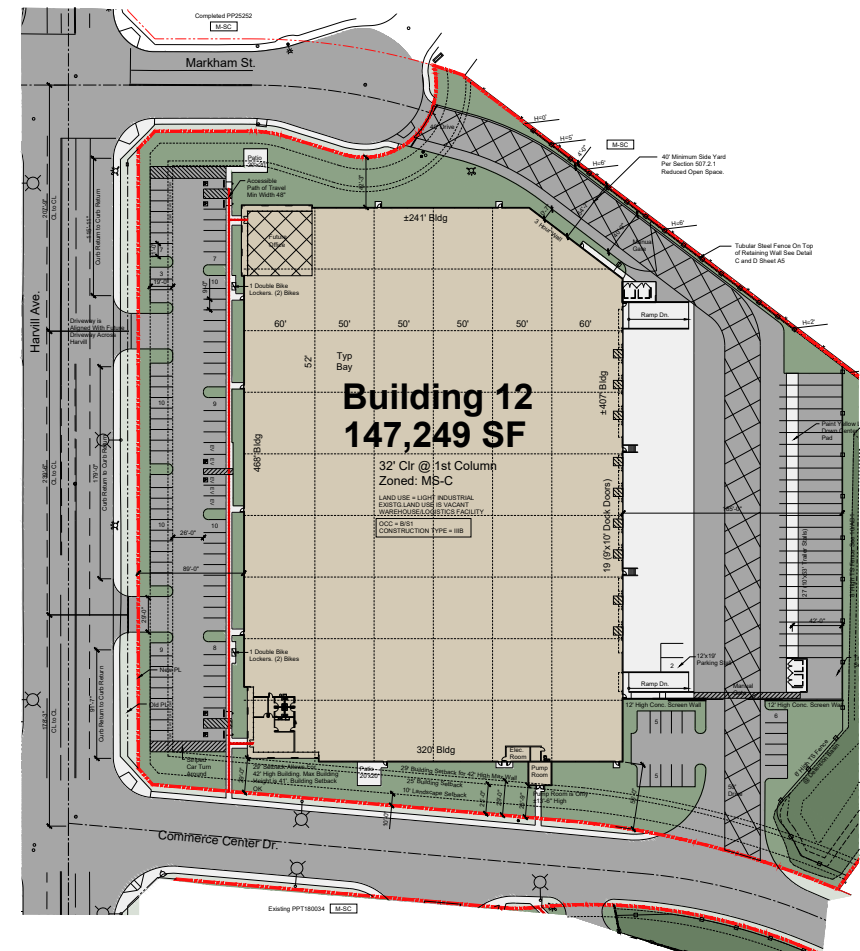

MAJESTIC FREEWAY BUSINESS CENTER RIVERSIDE COUNTY, CA

LOCATION

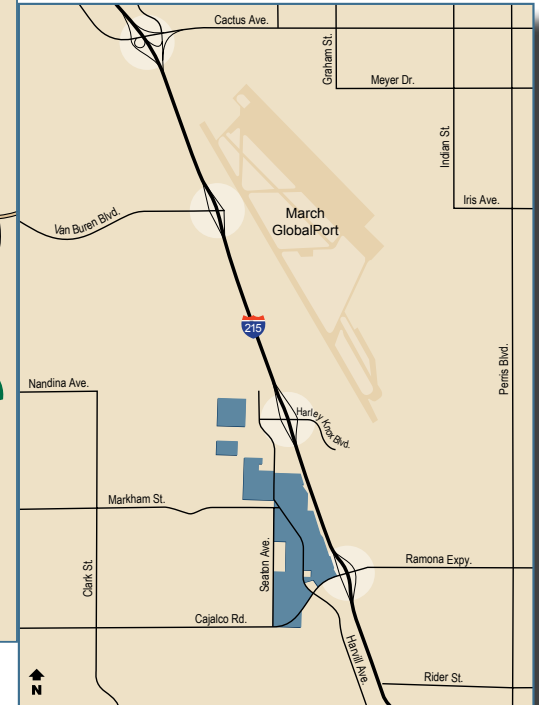

The Majestic Freeway Business Center is located between Harley Knox Boulevard and Cajalco Road on the I-215 Freeway in Riverside County, California.

MAJESTIC FREEWAY BUSINESS CENTER RIVERSIDE COUNTY, CA

CORPORATE NEIGHBORS



This statement is based upon information which we believe to be correct and is obtained from sources we regard as reliable but we assume no liability for errors or omissions therein.