



# FREEWAY IDENTITY

AVAILABLE FOR LEASE  
97,000 SQUARE FEET



**2550 PELLISSIER PLACE, CITY OF INDUSTRY, CA**

## BUILDING FEATURES

Office Space: 6,500 Square Feet  
Clearance: 26' minimum at 1st column  
Calculated Fire Sprinklers: .60 GPM/3,000 S.F.  
Power: 400 amps, 277/480 volts, 3 phase, 4 wire  
Lighting: 400 Watt Metal Halide  
Loading: 11 dock high loading doors  
1 ground level ramp  
Parking Spaces: 60 Cars  
Access: Excellent Freeway Access



Terry Baker (562) 948-4341  
R.E. License #00711593 (CA)  
tbaker@majesticrealty.com



# FREEWAY IDENTITY

## AVAILABLE FOR LEASE

### 97,000 SQUARE FEET

2550 PELLISSIER PLACE, CITY OF INDUSTRY, CA

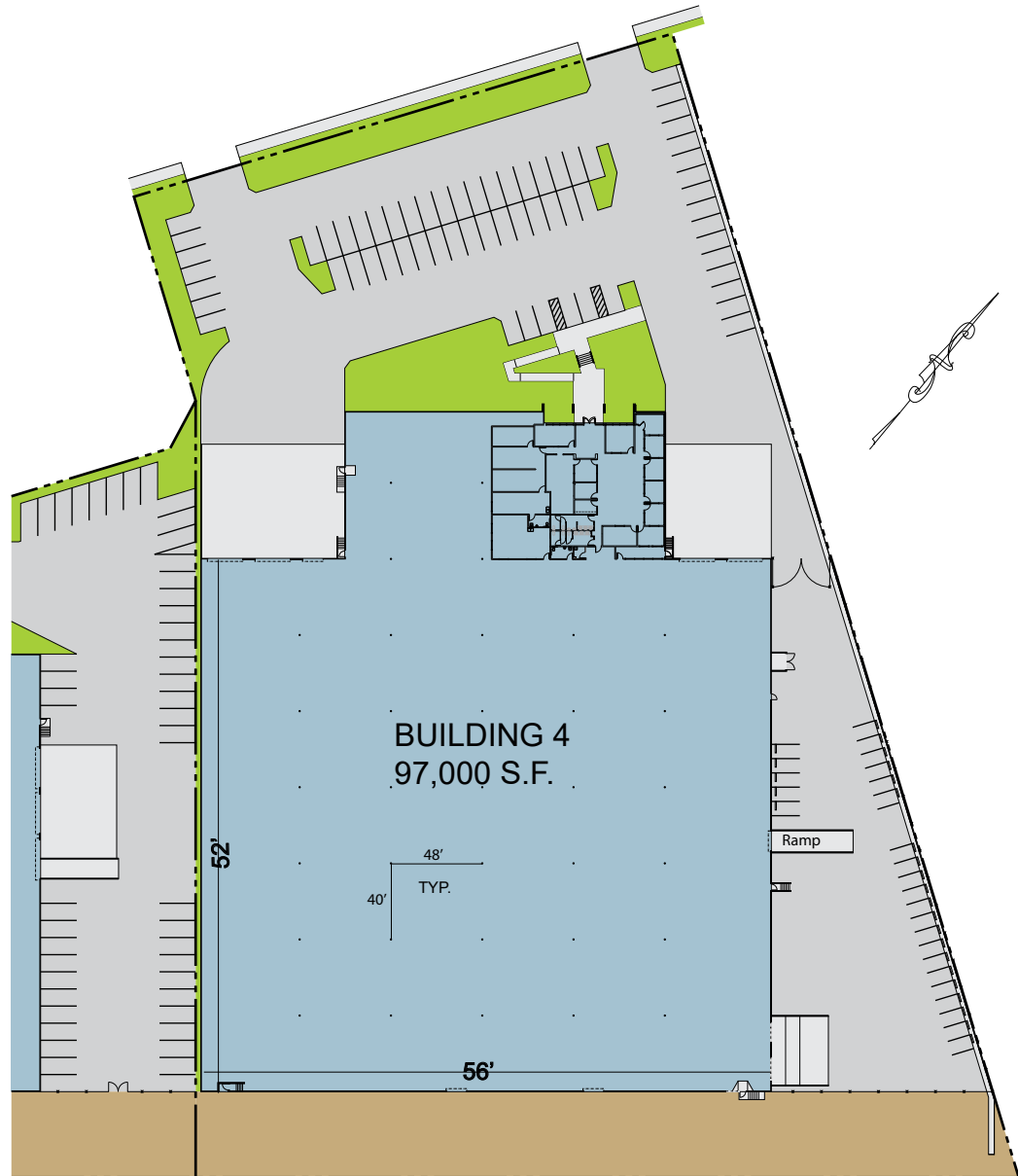

Terry Baker (562) 948-4341  
R.E. License #00711593 (CA)  
tbaker@majesticrealty.com

13191 Crossroads Parkway North, Sixth Floor | City of Industry, CA 91746-3497 | [www.majesticrealty.com](http://www.majesticrealty.com) | R.E. License #00255328 (CA)

This statement is based upon information which we believe to be correct and is obtained from sources we regard as reliable but we assume no liability for errors or omissions therein.