

**FOR LEASE**  
**150,000 SF on 6.89 Acres**



**Building 28: 14035-14045 Pipeline Ave, Chino, CA**

**FEATURES**

- Main Office:** 5,020 SF
- Whse Office:** 489 SF
- Clearance:** 30' at First Column
- Sprinklers:** ESFR w/ K-17 Heads
- Power:** 1,200 Amp, 277/480 Volts, 3 Phase
- Loading:** 26 Dock High Doors w/ Vision Panels
  - 13 w/ 30,000 lb. Capacity Mechanical Pit-Levelers
  - 13 w/ 25,000 lb. Capacity EOD Levelers
- 1 Ground Level Ramp**
- Parking:** To Code
- Whse Lighting:** LED w/ Motion Sensors
- Truck Court:** Fully Secured (Shared)

Part of a 5 Million SF Master Planned Business Park

Adjacent to Chino Valley (71) Fwy With Access to O.C. via  
 Riverside (91) Fwy & L.A./Ontario via Pomona (60) Fwy



13191 Crossroads Parkway North, 6th Floor, City of Industry, CA 91746  
 (562) 692-9581 | www.majesticrealty.com | R.E. License #00255328 (CA)

**Mitch Embrey**  
 (562) 654-2726  
 membrey@majesticrealty.com  
 R.E. License #02058837 (CA)

**Trent Wylde**  
 (562) 948-4315  
 twylde@majesticrealty.com  
 R.E. License #01180856 (CA)

# Building 28 / Site Plan

150,000 Square Feet



Building Site Plan

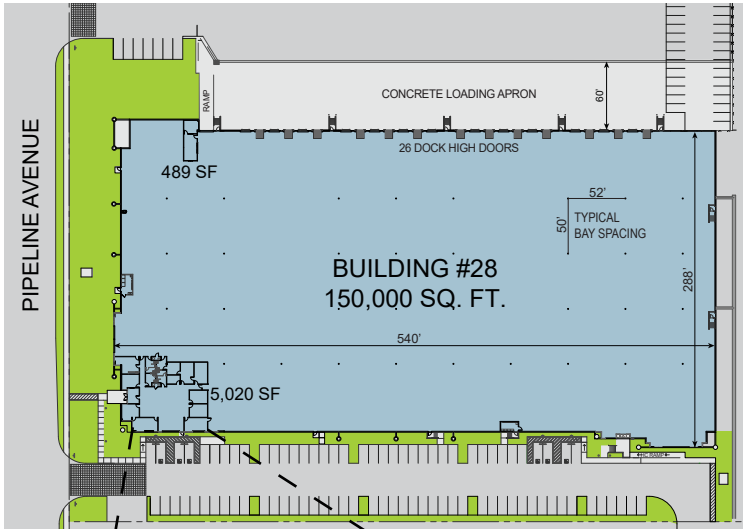

Office Floor Plan

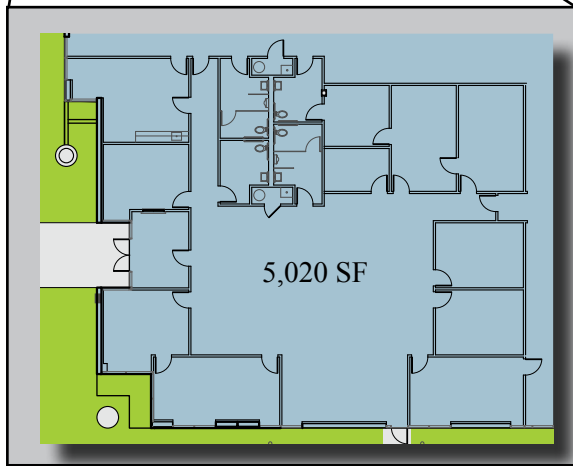

Industrial Park Master Site Plan

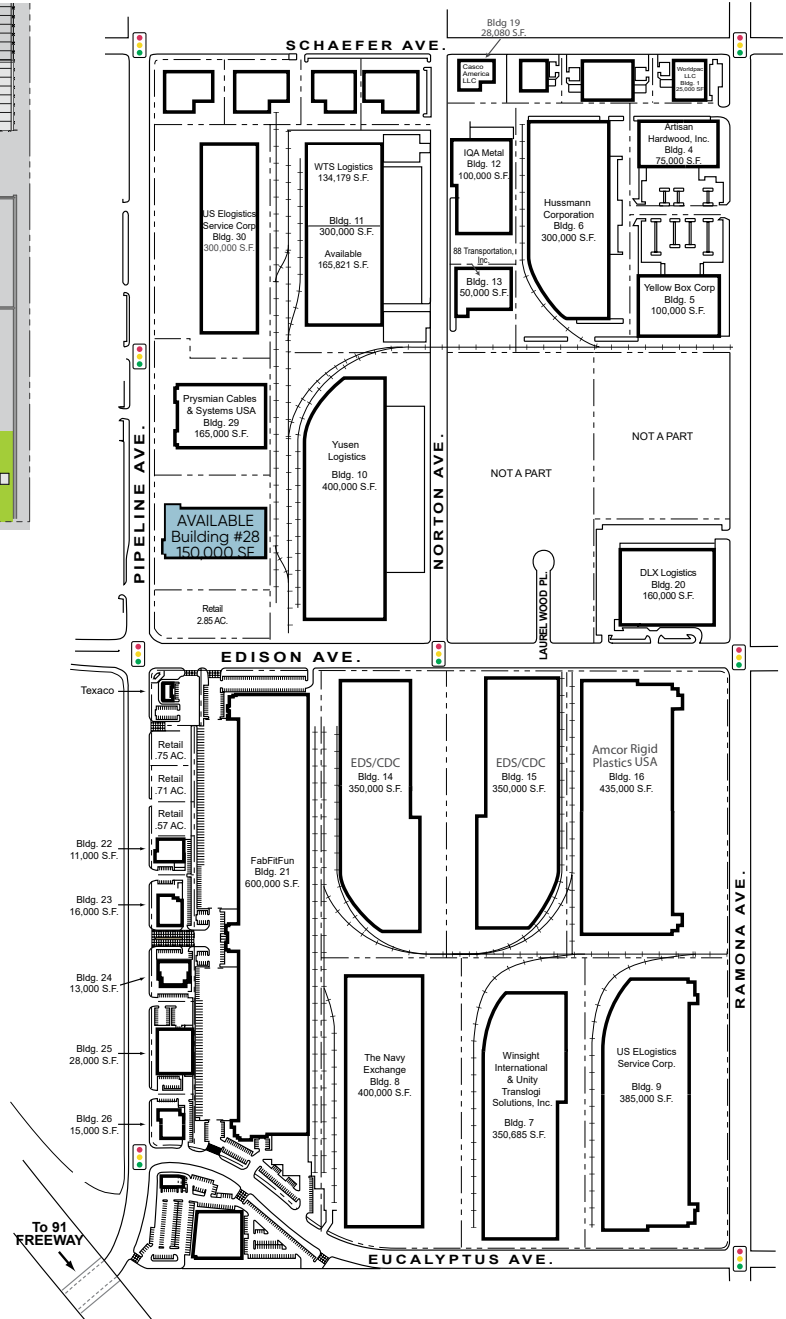

13191 Crossroads Parkway North, 6th Floor, City of Industry, CA 91746  
(562) 692-9581 | www.majesticrealty.com | R.E. License #00255328 (CA)

Mitch Embrey

(562) 654-2726

membrey@majesticrealty.com

R.E. License #02058837 (CA)

Trent Wyld

(562) 948-4315

twylde@majesticrealty.com

R.E. License #01180856 (CA)